

Cannabis Lab Solutions

for the Medical Marijuana Industry

UniMax Cannabis & Hemp Extraction Fume Hoods

*Exhaust hazardous fumes,
vapors, particulate, odors
& ventilate botanical extraction
processes.*



Laboratory Furniture

*Base cabinets, Worksurfaces, Fume Hoods,
Emergency Safety showers*

Medical Marijuana

*Analytical Testing Laboratories
HEPA / Carbon Filtered Clean Room*



HEM CO
CannabisLabSolutions.com

Find our products on
ARCAT.com

For Prompt Service
Call (816) 796-2900

UNIMAX CANNABIS EXTRACTION FUME HOODS



UNIMAX FLOOR MOUNTED EXTRACTION HOODS

are designed to safely isolate materials and procedures from the surrounding area, and exhaust hazardous fumes. 16'w X 6'd X 12'h Cat.No.161072

UNIMAX CANNABIS EXTRACTION FUME HOOD LIGHTING



Explosion Proof Light for Extraction Hoods (U.S.)
115V/230V. Factory mounted, not wired. UL listed. Class I Div I Group C, D, Class II Div I Group E, F & G Cat. No. 50038



Explosion Proof Light (Canada)
115V/230V UL listed. Class I Div II Group A, B, C, D Class II Div II Group F & G Cat. No. 50034

FIRE SUPPRESSION SYSTEM (see above)

Designed to fit all UniMax Extraction Hoods. HEMCO automatic dry chemical fire suppression systems are of the pre-engineered type as defined by the NFPA Standard for Dry Chemical Extinguishing Systems, NFPA-17. Meets requirements of Fire Marshals and local building codes, all components are UL listed.

Monoammonium Phosphate based dry chemical agent for ABC fires, (designed to suppress carbonaceous solid, liquid, gas or electrical fires). Upon actuation, the system discharges a pre-determined amount of agent into the fume chamber. The shutdown of fuel and power to the fume chamber is required upon system actuation. Exhaust fan(s) in the ventilation system must be shut off during system discharge to allow the proper concentration of agent to build up in the fume chamber.

HAZMAX CONTAINMENT BASINS

Designed to fit all UniMax Extraction Hoods. HazMax Floor Mounted Hoods have a molded one-piece seamless composite resin spill containment basin. The basin is 8" high and includes a raised fiberglass deck grating. An optional ramp can be supplied for roll up/in access or basin can be recessed into existing floor.

HazMax Spill Containment

- Lower basin is of molded one piece seamless chemical and fire resistant composite resin to safely contain accidental spillage.
- Raised deck grating is of chemical resistant fiberglass material that allows spillage to flow through to basin below. Self draining to a single point drain. Engineered to meet the anticipated weight loads.
- Convenient lift out grating allows access to basin for cleaning and decontamination.
- The lower basin can be engineered to contain a specified volume.



UNIMAX (EXTRACTION) HOODS DESCRIPTIONS

Select a UniMax hood size. A. select width, B. select height, C. select depth

UniMax Floor Mount Hood Enclosures are perfect for the cannabis industry to isolate, contain, and vent extraction equipment processes. These hoods are designed to meet the size requirements and accessibility needs.

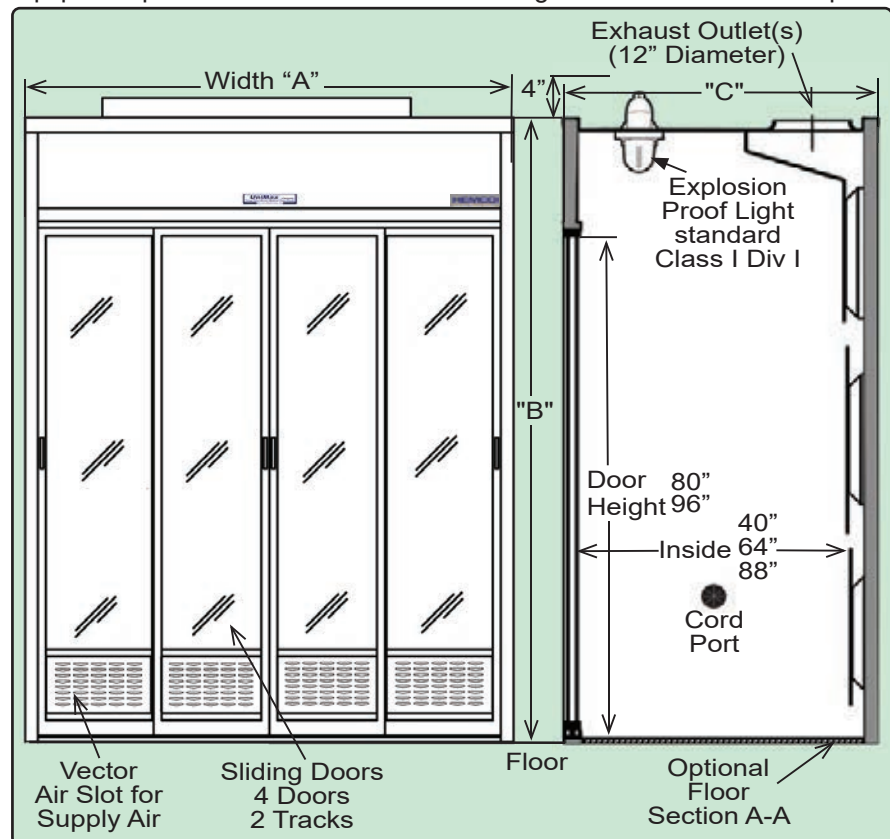

Dimensions		Depth "C"			Number of Exhaust Outlets
Width "A"	Height "B"	48" outside 42" inside	72" outside 66" inside	96" outside 90" inside	
6'	8'	60848	60872	60896	(1) 12" Dia
	10'	61048	61072	61096	
	12'	61248	61272	61296	
8'	8'	80848	80872	80896	(2) 12" Dia
	10'	81048	81072	81096	
	12'	81248	81272	81296	
10'	8'	100848	100872	100896	(2) 12" Dia
	10'	101048	101072	101096	
	12'	101248	101272	101296	
12'	8'	120848	120872	120896	(3) 12" Dia
	10'	121048	121072	121096	
	12'	121248	121272	121296	
16'	8'	160848	160872	160896	(4) 12" Dia
	10'	161048	161072	161096	
	12'	161248	161272	161296	
20'	8'	200848	200872	200896	(5) 12" Dia
	10'	201048	201072	201096	
	12'	201248	201272	201296	
24'	8'	240848	240872	240896	(6) 12" Dia
	10'	241048	241272	241296	
	12'	241248	240272	240296	

UNIMAX CANNABIS EXTRACTION FUME HOOD SPECIFICATIONS

(Consult factory for custom size requirements, optional sizes available to your specs.)

UniMax Floor Mount Extraction Hoods are constructed and equipped as follows:

- Modular walls are of 2" thick rigid foam faced with chemical resistant and fire retardant composite resin panels that meets ASTM E-84 for a flame spread of less than 25.
- Structural framework is of clear anodized aluminum extrusions, non-sparking.
- Ceiling is fabricated of chemical resistant and fire retardant composite resin with molded-in exhaust duct connection collars.
- VaraFlow slotted rear baffle is factory installed.
- Front of hood shall have a horizontal slide door assembly with (4) aluminum framed tempered glass doors on (2) lower floor tracks.
- Explosion proof Class I Div I light fixtures are installed. Switch, bulb, and wiring are by others.
- (2) 3" Cord ports.

UNIMAX ENTRY ACCESS DOORS

Select the type of door required. Add FG, UG, FS, SC as suffix to hood model number.

✓ FS – Framed Glass Doors with Floor Track

Horizontal sliding door assembly includes (4) aluminum framed 3/16" tempered glass doors on (2) floor tracks with air bypass Vector inlet grills at the base of each door.

✓ FG - Framed Glass Door with Overhead Suspension

Horizontal sliding door assembly includes (4) aluminum framed 3/16" tempered glass doors on (2) overhead tracks with air bypass inlet Vector grills at the base of each door.

✓ UG - Unframed Glass Door with Overhead Suspension

Horizontal sliding door assembly includes (4) unframed 3/8" tempered glass panels on (2) overhead tracks with air inlet slots at the base of each door.

✓ SC - Strip Curtains

Clear vinyl 6" wide strip curtains suspend from overhead bracket track with 6" high air inlet gap below the curtains



UniMax 16'w X 8' d X 10'h
Catalog No.# 80848/FS/F

Medical Marijuana Analytical Test Laboratories



**HEPA Filtered,
Clean Rooms
Class 100,000 see page 10**

**Optional
Changing Room
see pages 5-7**

SPECIFICATIONS

(Room #1 see page 5, Room #2 see page 6, Room #3 See page 7, custom sizes available to specs.)

ROOM CONSTRUCTION FEATURES: wall panels are Class A and are mounted into a clear anodized aluminum framing. Standard wall panels are 48" w x 120" h x 3" thick and are constructed with a foam core sealed between 1/2" gypsum and surfaced with chemical resistant composite resin panels with smooth white finish. Available with optional Room.

T-GRID CEILING SYSTEM: 1-1/2" Aluminum ceiling grid with white painted finish positioned 8' above floor. Includes all connectors, suspension hardware to hang from corrugated steel roof deck.

MYLAR CEILING PANELS: have sealed edges for spaces not occupied by fan filter units or light fixtures.

ENTRY DOOR: (1) 36" W X 80" H Door with viewing window, passage lever and hinges & lock.

WINDOWS: Nominal 46" W X 39" H, 1/4" tempered glass, mounted in an anodized aluminum frame. (optional windows can be added to meet your specs)

LIGHTING: LED 2' X 4' panel light fixtures, ceiling mount, 115V.

SINGLE-PASS DESIGN: Ambient surrounding air is drawn into the Clean Room Fan Filter Units at the ceiling level. The filtered air passes into the clean lab and is transferred out of the room through either the fume hood or general exhaust grills. Room is clean but under slight negative pressure.

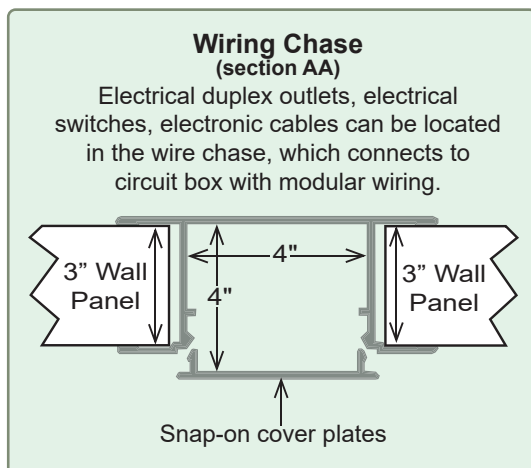

HEPA FILTERED SUPPLY AIR: 2' X 4' Fan Filter units, Module features a 99.99% efficient @ 0.3 micron HEPA filter with, 90 FPM @ initial 0.47 w.g., 115v low watt A/C, 60Hz 1ph, includes prefilter, on/off/variable speed control, powder coated steel housing. see page 10

CLEAN AIR IN-LINE CARBON FILTRATION EXHAUST AIR: Filters are loaded with virgin coconut activated carbon to efficiently absorb organic solvents and acid fumes. The filter pak housing features a hinged access door with gaskets and spring latches for convenient filter changes. see page 10

EXHAUST BLOWERS: Standard (STD) belt drive steel blower and impeller wheel are epoxy coated for superior chemical resistance. Explosion-proof blowers (EXP) have epoxy coated, non-sparking aluminum impeller wheel. V-belt drive and adjustable pulleys permit field balancing. see page 10

Plan View Room #1 Cat. No. 80812 (12' X 8' X 10')

Room 1 includes: laboratory base cabinets, worksurfaces (black). Request a tech data sheet for room specifications. Maximum Occupancy 1-2 people.

Cat. No. 80812 Room #1 Description

12'w X 8'd x 10' h Modular Lab with 8' ceiling

Solid Walls are 3' thick with smooth PVC on 1/2" gypsum with rigid foam core

(1) Door shall be 3' W X 7' h, painted steel, hinged door, half glass

(2) LED flat panel light fixture 2' X 4', 115V with modular wiring 115V

(1) Filtration module, 2' X 4', with 99.99% efficient HEPA filter, prefilter integral fan and speed control 115V

(2) Windows are 1/4" tempered glass

(4) Duplex receptacles and light switch with modular wiring

(1) Circuit box, 100 amp, 6 circuits with modular wiring

(2) Data (cabling not included)

(1) Changing Room, construction same as room construction except (1) additional LED light & switch

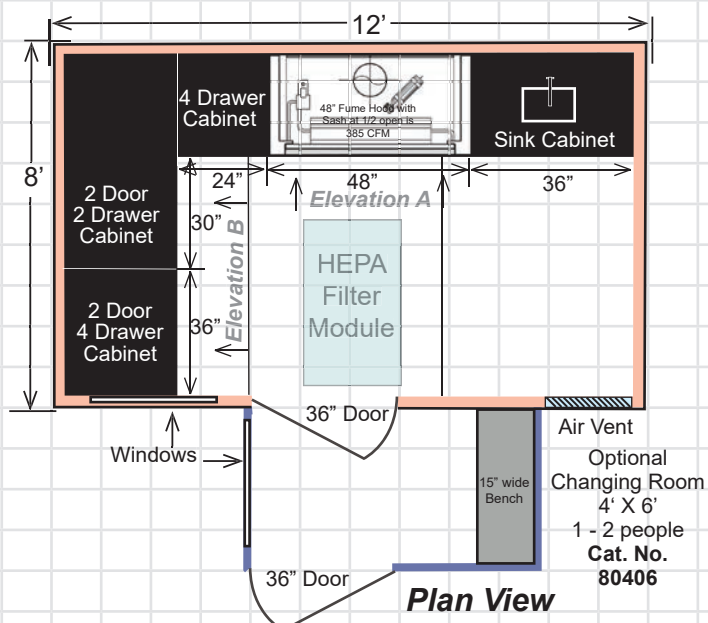

Laboratory Furniture Specifications for Room #1 Cat.No.80812		
Elevation A		
Cat. No	Description	Qty
35463	48" LE Fume Hood	1
71222	24" 4 Drawer Cabinet	1
54811	48" 2 Door Cabinet	1
71812	36" Sink Unit	1
50026	Faucet	1
42022	Sink 16" X 12"	1
70018B	Phenolic Worksurface & Backsplash	1
Elevation B		
71102	36" 4 Drawer 1 Door Cabinet	1
71062	30" 2 Door 2 Drawer Cabinet	1
70018B	Phenolic Worksurface & Backsplash	1

Note: Exhaust Blowers and carbon filtration modules are available to safely exhaust and filter odors from the fume hood. Knowing the length of the ducting and the number of elbows in the duct run will enable us to properly size the blower and filter module to your specific requirement.

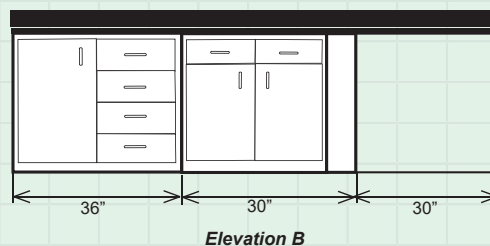
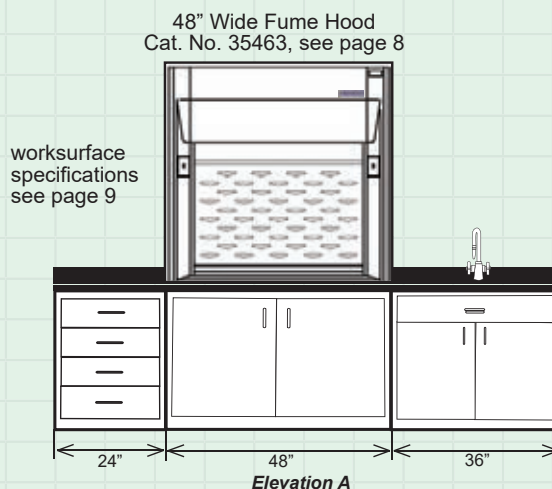

Elevation View of Laboratory Furniture Layout

Plan View Room #2 Cat. No. 81216 (16' X 12' X 10')

Room 2 includes: laboratory base cabinets, worksurfaces (black). Request a tech data sheet for room specifications. Maximum Occupancy 3-4 people.

Cat. No. 81216 Room #2 Description

16'w X 12'd x 10' h Modular Lab with 8' ceiling

Solid Walls are 3' thick with smooth PVC on 1/2" gypsum with rigid foam core

(1) Door shall be 3' W X 7' h, painted steel, hinged door, half glass

(2) LED flat panel light fixture 2' X 4', 115V with modular wiring 115V

(1) Filtration module, 2' X 4', with 99.99% efficient HEPA filter, prefilter integral fan and speed control 115V

(2) Windows are 1/4" tempered glass

(6) Duplex receptacles and light switch with modular wiring

(1) Circuit box, 100 amp, 6 circuits with modular wiring

(2) Data (cabling not included)

(1) Changing Room, construction same as room construction except (1) additional LED light & switch

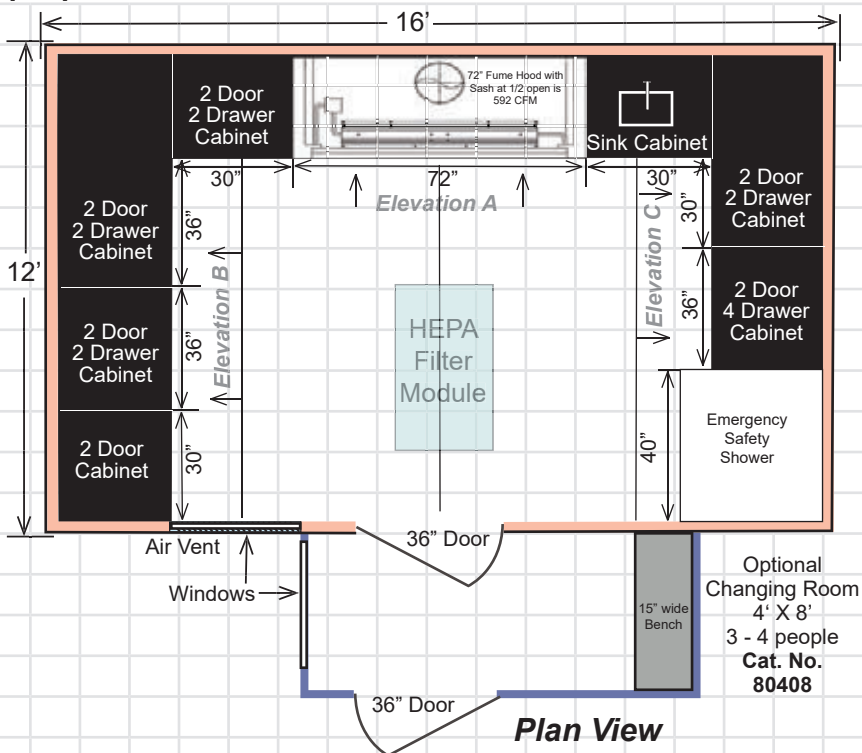

Laboratory Furniture Specifications for Room #2 Cat.No.81216

Elevation A

Cat. No	Description	Qty
35563	72" LE Fume Hood	1
74112	7" Filler Panel	2
71061	30" 2 Door 2 Drawer	1
71062	36" 2 Door Cabinet	2
71811	30" Sink Unit	1
50026	Faucet	1
42022	Sink 16" X 12"	1
70018B	Phenolic Worksurface & Backsplash	1

Elevation B

71062	30" 2 Door Cabinet	1
71062	36" 2 Door 2 Drawer Cabinet	2
74112	7" Filler Panel	1
70018B	Phenolic Worksurface & Backsplash	1

Elevation C

74112	7" Filler Panel	1
71061	30" 2 Door 2 Drawer	1
71102	36" 1 Door 4 Drawer	1
70018B	Phenolic Worksurface & Backsplash	1
16601	40" Safety Shower	1

Note: Exhaust Blowers and carbon filtration modules are available to safely exhaust and filter odors from the fume hood. Knowing the length of the ducting and the number of elbows in the duct run will enable us to properly size the blower and filter module to your specific requirement.

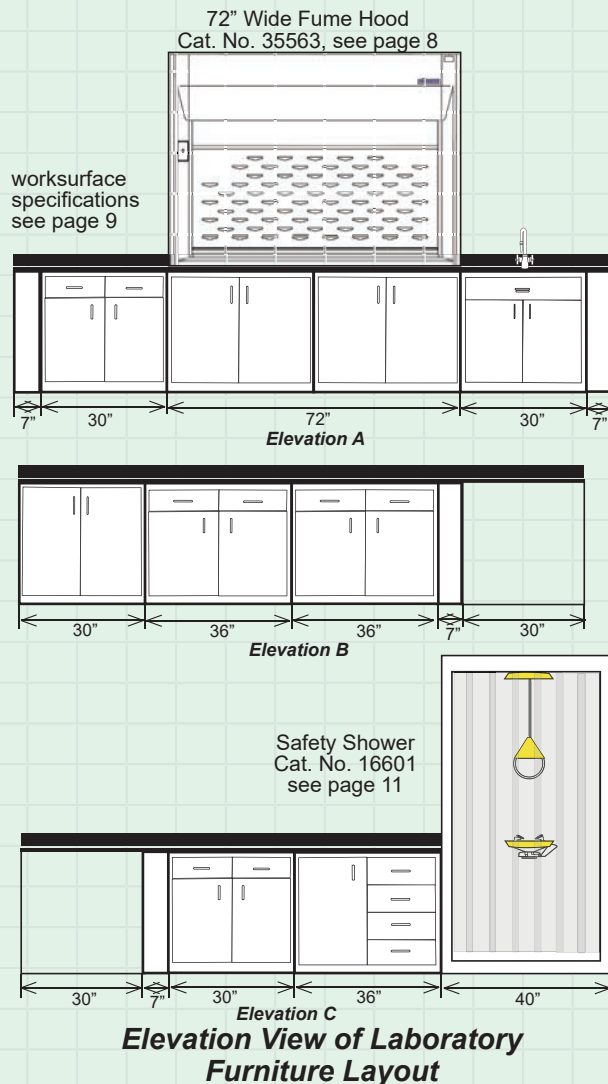

Plan View Room #3 Cat. No. 81624 (24' X 16' X 10')

Room 3 includes: laboratory base cabinets, worksurfaces (black). Request a tech data sheet for room specifications. Maximum Occupancy 5-7 people.

Cat. No. 81624 Room #3

Description

24'w X 16'd x 10' h Modular Lab with 8' ceiling

Solid Walls are 3' thick with smooth PVC on 1/2" gypsum with rigid foam core

(1) Door shall be 3' W X 7' h, painted steel, hinged door, half glass

(3) LED flat panel light fixture 2' X 4', 115V with modular wiring 115V

(2) Filtration modules, 2' X 4', with 99.99% efficient HEPA filter, prefilter integral fan and speed control 115V

(4) Windows are 1/4" tempered glass

(10) Duplex receptacles and light switch with modular wiring

(1) Circuit box, 100 amp, 6 circuits with modular wiring

(2) Data (cabling not included)

(1) Changing Room construction same as room construction except
(1) additional LED light & switch

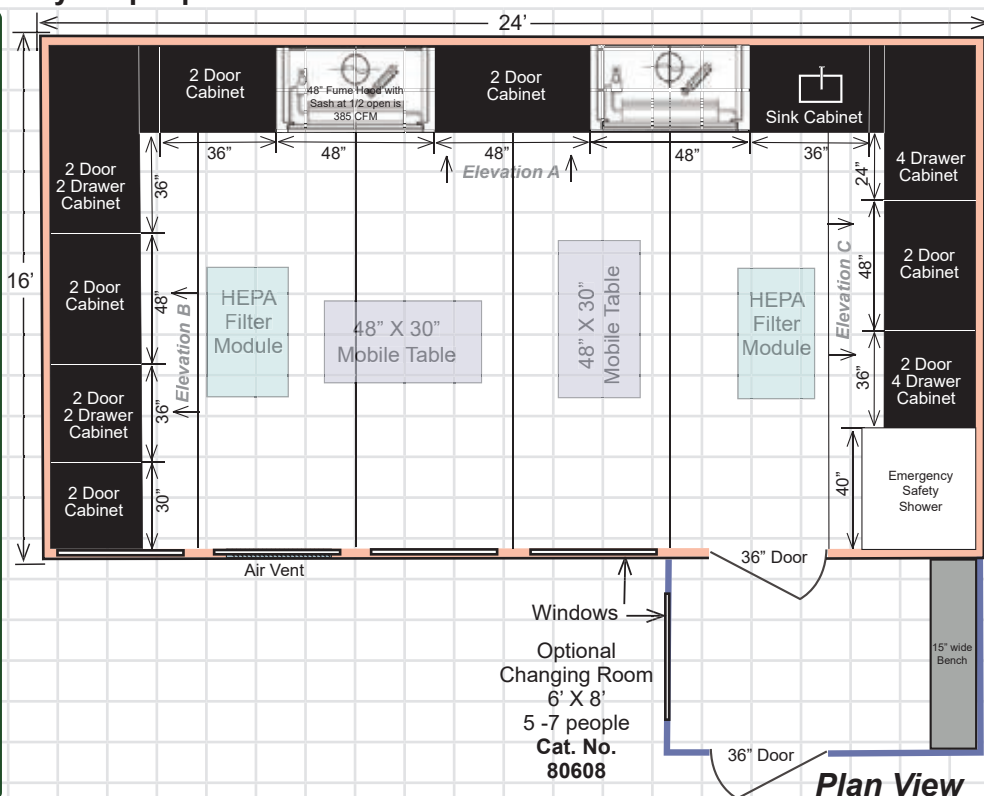

Laboratory Furniture Specifications for Room #3 Cat.No.81624

Elevation A

Cat. No	Description	Qty
35463	48" LE Fume Hood	2
71062	36" 2 Door Cabinet	1
54811	48" 2 Door Cabinet	3
71812	36" Sink Unit	1
74112	7" Filler Panel	1
50026	Faucet	1
42022	Sink 16" X 12"	1
70018B	Phenolic Worksurface & Backsplash	1

Elevation B

71062	30" 2 Door Cabinet	1
71062	36" 2 Door 2 Drawer Cabinet	2
54811	48" 2 Door Cabinet	1
74112	7" Filler Panel	1
70018B	Phenolic Worksurface & Backsplash	1

Elevation C

74112	7" Filler Panel	1
71222	24" 4 Drawer	1
54811	48" 2 Door Cabinet	1
71062	36" 2 Door 2 Drawer Cabinet	1
16604	40" Safety Shower	1
70018B	Phenolic Worksurface & Backsplash	1

Note: Exhaust Blowers and carbon filtration modules are available to safely exhaust and filter odors from the fume hood. Knowing the length of the ducting and the number of elbows in the duct run will enable us to properly size the blower and filter module to your specific requirement.

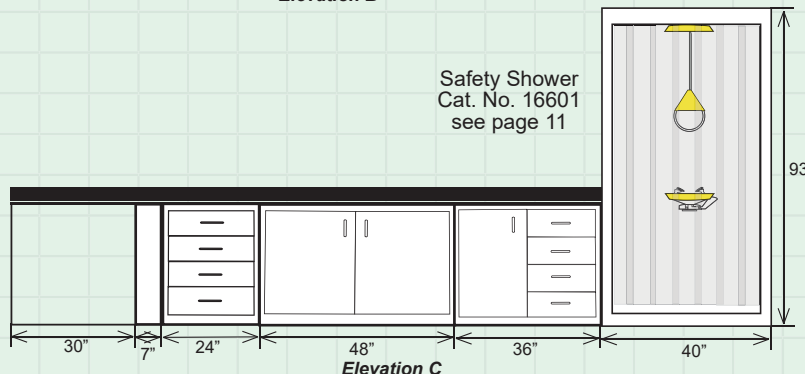
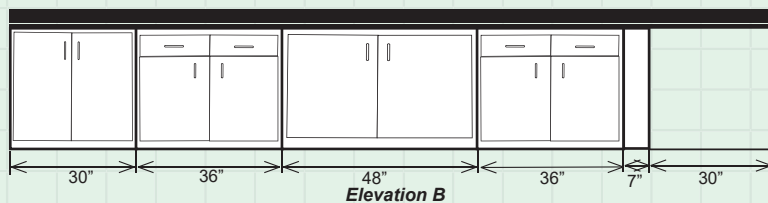
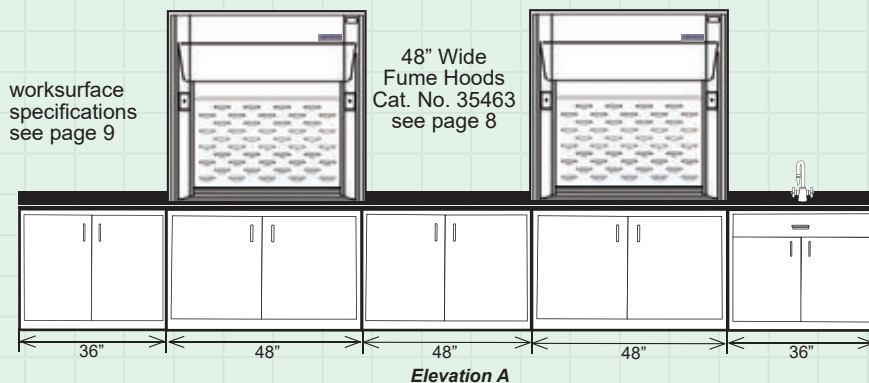

Elevation View of Laboratory Furniture Layout

UniFlow LE AireStream Laboratory Fume Hoods



UniFlow LE AireStream Hood Cat. No. 35663 shown with factory installed phenolic resin worksurface, base cabinet and fixtures.



High efficiency, full duty fume hood in 48" and 72" widths. UniFlow LE AireStream Fume Hoods are low flow constant volume for energy savings & maximum user protection. Requires Remote Exhaust Blower. Hood is U.L. 1805 classified.

Phenolic Resin Worksurface 1 1/4" thick, dished, supplied and factory installed to bottom of hood.

UniFlow LE AireStream Fume Hoods			
Width	Depth	Height	Cat. No.
48"	30"	48"	35463
60"	30"	48"	35563
72"	30"	48"	35663
96"	30"	48"	35863

Optional sizes available to your specs.

VaraFlow Air Bypass low flow, constant air volume hood. Dual wall unitized construction, all non-metallic corrosion and fire resistant composite construction. Molded one-piece fume chamber with white glass-smooth surface with all covered corners.

Vector AireStream Baffle System and bell shaped exhaust collar.

Sash to be counterbalanced, 3/16" tempered safety glass with chemical resistant non-metallic PVC framing, track & aerodynamic sash lift.

Sash Stop at half open for energy efficiency and user protection. A sash stop is installed at the half open position.

28" Vertical Sash Height provides ease of access for apparatus set-up in fume chamber. Standard Sash. 32" Viewing Height interior fume chamber with 24" interior reach in depth.



Explosion-Proof Light Std Class I Div II For use in hazardous locations. Gray, two-coat epoxy finish with easily removed prismatic globe. Factory mounted, not wired. Accepts compact fluorescent or LED, (bulb not included) 115V /230V UL listed. Class I Div II Group A, B,C,D Class II Div II Group F& G



Optional Fire Extinguisher automatic activation at 165° Fahrenheit, With dry chemical for class ABC fires, 20 Square feet. **Cat No. 53020**

Fume Hood Base Cabinets



Base Cabinet Constructed of furniture grade steel. With adjustable shelf and levelers. Doors feature double wall construction. Standard depth is 22", standard height is 35". White powder coat finish.

Width	Cat. No.
30"	53011
36"	53611
48"	54811
Filler Panels (2)	74112
Door Lock	75001



Acid Cabinet provides safe storage of acids. Molded furniture grade one piece chemical resistant, composite liner, covered corners, glass smooth for ease of cleaning. Standard depth is 22", standard height is 35". White powder coat finish.

Width	Doors	Cat. No.
30"	2	15300
36"	2	15360
48"	2	15480
Vent Kit	---	81000
Filler Panels (2)		74112
Door Lock		75001



Flammable Cabinet provides safe storage of flammables. Constructed of welded double wall furniture grade steel. Standard depth is 22", standard height is 35". White powder coat finish. With locking handle.

Width	Cat. No.
30"	18300
36"	18030
48"	18040
Filler Panels (2)	74112

When Flammable cabinets are vented it voids UL Listing, Sealed doors smother any flame.

Laboratory Base Cabinets & Worksurfaces

Lab cabinets are offered in standard modular sizes that allow you to create a custom laboratory to meet your specific needs. Cabinets feature furniture grade welded steel construction with a durable, chemical resistant, epoxy powder coat finish. **Base Cabinets (standard color: Lab White)**

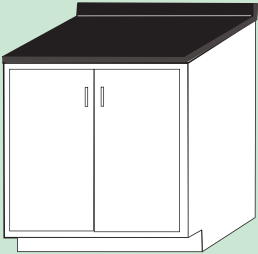

2 Door

Width	Depth	Cat. No.
30"	22"	53011
36"	22"	53611
48"	22"	54811



2 Drawer - 2 Door

Width	Depth	Cat. No.
30"	22"	71061
36"	22"	71062
48"	22"	71064



4 Drawer - 1 Door

Width	Depth	Cat. No.
30"	22"	71101
36"	22"	71102
48"	22"	71104



Sink Unit Cabinet

Width	Depth	Cat. No.
30"	22"	71811
36"	22"	71812
48"	22"	71814



4 Drawer Cabinet

Width	Depth	Cat. No.
18"	22"	71221
24"	22"	71222

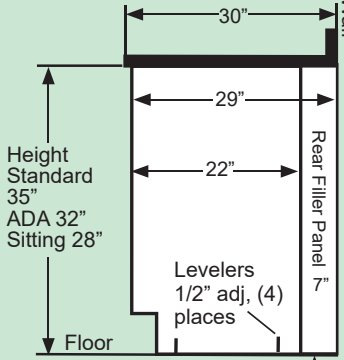

Rear Filler Panel
35" high x 7" wide. Used to enclose pipe chase behind cabinets on standard 30" deep counters.
Cat. No. 74112



Standard Lab Bench Stands
with 1" Phenolic Resin worksurface

Mobile Table (Height adjustable 30", 32", 36"H)		
Width	Depth	Cat.No.
48"	30"	54812
72"	30"	57212

UniLine Laboratory Casework Construction

UniLine Casework is constructed of welded 18 gauge steel. Base cabinets have a load capacity of 500 pounds per linear foot. Powder coat finish is environment friendly, attractive and long lasting, color: Lab White. UniLine casework, quality & style for your laboratory.



48" Cabinet shown Cat. No. 71064

35" Height

7" Depth

22" Depth

Rear Filler Panel Cat. No. 74112

Made in the USA

- Drawers extend to 18" full open, Interchangeable, interlocking drawer head, sound deadened for quiet operation. One piece drawer body with radiused bottom for easy cleaning. 150 pound dynamic drawer slide assembly mounted on welded channel assemblies. Interior is powder coated steel, stainless steel interior is optional.
- Doors One-piece double wall construction painted before assembly. Insulated door filler for added rigidity and quiet operation. Rubber door bumpers. Powder coated finish.
- Cabinet Interior Minimal holes in front post for aesthetically pleasing appearance. Hem and flatten door. Adjustable shelves heavy duty stop for secure closure. Full length & width adjustable shelf for maximum storage. Unique triangular support rails for added strength. Heavy duty plated steel shelf clips. Powder coated finish. Cabinet interior bottom with a radius flange for increased strength and ease of cleaning.
- Recessed Toe Space 4 inches high 3-1/2 inches deep, promotes laboratory cleanliness. Cabinet base lower corner reinforcing gusset with 0 to 2-1/2" adjusting levelers on (all four corners). Cabinet height adjustable from 35" to 37".

HEPA Filtered Air Module supplies air into Testing laboratories

Fan Powered Module

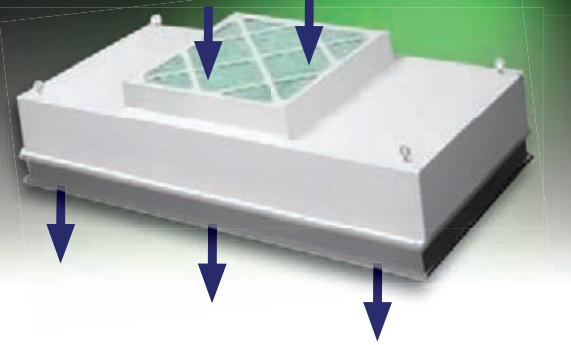

- Module features a 99.99% efficient @ 0.3 micron HEPA filter with, 90 FPM @ initial 0.47 w.g., 115v low watt A/C, 60Hz 1ph, includes prefilter, on/off/variable speed control, powder coated steel housing.
- HEPA filters can be changed from inside the enclosure, without removing the unit from the ceiling, can be ordered with optional integral lighting. Available with Magnehelic gauge **Cat. No. 51301**

Size	With out lights
24" X 48"	50324

Filter units feature an upstream gel channel on the final filter which provides a leak-free seal between the filter and the housing.

Replacement Filters

	Cat. No.
Prefilter, 30% efficient 20" X 20" X 1"	52190
HEPA filter 99.99% efficient (Inside Replaceable) (for 24" X 48" module)	52200

Clean Air In-Line Carbon Filtration Exhaust Systems for capturing Cannabis odors

Note: HEMCO recommends a minihelic or magnehelic gauge to monitor the air flow differential across the filter. The static pressure indicated would alert when to change filter. The gauges can be hood or filter mounted. We recommend ordering a back-up replacement filter. Designed to clean up fume hood exhaust fumes. Carbon filtration removes unwanted odors & vapors. Select your fume hood exhaust blower from the chart below.

In-Line Carbon Filter Pak



Clean Aire Carbon Filter Pak					
CFM	Size		Duct Size		Cat. No.
250-650	26" x 15" x 35 1/2"		4", 8" diameter		50297
650-1200	26" x 26" x 35 1/2"		8", 10", 12" diameter		50298
Carbon Filters			Prefilter (6 per carton)		
CFM	Size	Cat. No	CFM	Size	Cat. No.
500	24" x 12" x 12"	52100	500	24" x 12" x 2"	52000
1000	24" x 24" x 12"	52101	1000	24" x 24" x 2"	52001

Fume Hood Epoxy Coated Steel Belt Drive Exhaust Blowers

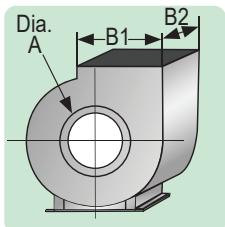

Standard (STD) belt drive steel blower and impeller wheel are epoxy coated for superior chemical resistance. Explosion-proof blowers (EXP) have epoxy coated, non-sparking aluminum impeller wheel. V-belt drive and adjustable pulleys permit field balancing. Seven discharge positions to suit installation. Weather housing is furnished. Motor has thermal overload protection. Specify: 115V single phase, 230V single phase, 230/460V three phase or 208V(consult factory). 1 year manufacturer's warranty

Catalog Number and Static Pressure															
CFM	A Inlet Dia	B1 Outlet Size	B2 Outlet Size	1/2" Static Pressure			3/4" Static Pressure			1" Static Pressure			1 1/2" Static Pressure		
				HP	STD	EXP	HP	STD	EXP	HP	STD	EXP	HP	STD	EXP
296	8 7/8"	10 1/8"	4 1/8"	1/4	51701	51801	1/4	51702	51802	1/4	51703	51803	1/4	51704	51804
800	8 7/8"	10 1/8"	6 3/8"	1/2	51713	51813	1/2	51714	51814	1/2	51715	51815	3/4	51716	51816
914	9 7/8"	11 1/2"	8 1/4"	1/2	51717	51817	1/2	51718	51818	—	—	—	—	—	—
1240	9 7/8"	11 1/2"	8 1/4"	1/2	51725	51825	1/2	51726	51826	3/4	51727	51827	3/4	51728	51828
1771	11 7/8"	13 3/8"	8 1/4"	1/2	51734	51834	3/4	51735	51835	3/4	51736	51836	1	51737	51837

Laboratory Emergency / Shower Decontamination Booths

Full body emergency shower & eye/face wash, both with immediate response activation handle.

Durable one-piece seamless fiberglass construction with glass smooth white surfaces and coved corners for ease of clean-up.

Emergency showers include translucent frosted strip curtains, which provides for easy access into booth, while containing contaminated water splash.

Stainless steel Grab bars located on right & left sides to support victim and rescue personnel during decontamination.

Plumbing is provided for installation by local certified plumber. Plumbed to single point 1.25" IPT. connection. Tempered warm water supply connection 20 GPM water supply is required.

Raised fiberglass deck with self draining containment basin, and 2" diameter drain outlet located on either the bottom or rear of unit.

Industrial Applications
Emergency Drench Shower Booth
 economical single wall unit is equipped with pull rod activated overhead drench shower and rear wall mounted eye/face wash.
Cat No. 16601

Laboratory Applications
Emergency Drench Shower Booth
 same specs as above except with finished exterior side panels.
Cat No. 16604



Note: OSHA & ANSI require that emergency shower is to be located within 10 seconds walking time from the hazardous site location.



Alarm Horn & Light
 Audible warning sounds when system is activated by flow switch. Top mounted visual warning light sounds when system is activated.
Cat. No. 16680

Optional Eye and Face Wash Accessories



Swing-Out Eye Wash
 Deck mounted next to sink. Activates when pivoted. 1/2" NPT. Barrier free.
Cat. No. 16009



Hand Held Body Wash
 Squeeze valve nozzle on 8' coiled hose and bracket. Can be used to rinse all body parts while victim is sitting or lying down. Wall or hood mounted, 3/8 NPT, barrier free.
Cat No. 16005



Hand Held Eye/Face & Body Wash
 Mounted on the front side-wall of the fume hood. Includes 8' hose and surface escutcheon. 3/8" NPT. barrier free.
Cat. No. 93966



Welcome to HEMCO

Made in the  U.S.A.

HEMCO is the leading manufacturer of innovative laboratory equipment since 1958, serving the Cannabis extraction, and Medical Marijuana Industries. Located in Independence, Missouri, the heart of America, and the crossroads of North America a major center for transportation, communication, distribution, and manufacturing industries worldwide. HEMCO's modern manufacturing and distribution facilities combined with our many years of experience uniquely qualifies us to provide laboratory planning solutions. Our extensive engineering, design and manufacturing expertise can transform your laboratory ideas into reality.



Membership in Technical Associations, Inspires Innovation



National Society of Professional Engineers
Lifetime Member



ASHRAE
American Society of Heating Refrigeration and Air-Conditioning Engineers
Lifetime Member



International Institute for Sustainable Laboratories
Member Since 2002



American Society of Mechanical Engineers



American Chemical Society
Chemical Health & Safety
Member Since 1989



International Society of Pharmaceutical Engineers
Member Since 1994



UL Underwriters Laboratories
Certified 1805 and 3101
Since 2010



ISO 9001:2015
Certified Company
Since 2009



UniFlow Laboratory Fume Hoods
Brochure



UniMax Large Floor Mount Walk-In Fume Hoods
Brochure



Laboratory Planning Solutions
Brochure

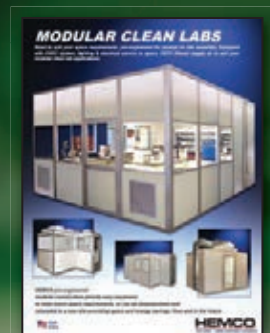

Modular Clean Room Labs
Brochure



Laboratory Ventilation
Brochure

HEM CO Corporation
711 S. Powell Road
Independence, MO 64056
CFHB-11.19

HEM CO
CannabisLabSolutions.com



Phone (816) 796-2900